

Eagles Nest or Fairway 10

Eagles Nest

- **\$50.00** for four hours, includes seating area/balcony
- **\$75.00** for entire day, includes service line, walk-in freezer and seating area/balcony

Ping Pong Tables now available

You can **rent** 2 paddles & 1 ball for:

\$1.00 **hourly** \$8.00 **daily** \$16.00 **weekend**

\$20.00 **holiday weekend** \$40.00 **weekly**

Fairway 10

- **Cleaning Deposit: \$50.00** (Paid by Visa or Master Card Only)
Cleaning deposit is required at the time of reservation. The deposit holds the reservation and will be returned after the Outdoor Recreation Staff is assured the park has been cleaned after the function. It is recommended that reservations be made a minimum of two weeks in advance.

BAMA Park

- **BAMA Park** is great for picnics, parties, unit parties, and other base functions and there is water and bathrooms available.

Cleaning Deposit: \$50.00 (paid by Visa or Master Card only)

Cleaning deposit is required at the time of reservation. The deposit holds the reservation and will be returned after the Outdoor Recreation Staff is assured the park has been cleaned after the function. It is recommended that reservations be made a minimum of two weeks in advance.

Outdoor Recreational Skate Park

The Skate Park is open from dawn to dusk for all authorized users. Skaters must stop by Outdoor Recreation and fill out a waiver/release of liability and receive a sticker for their helmet. Anyone under 18 years of age must have their parent or legal guardian sign the waiver/release of liability. Safety gear must be worn at all times while using the park.

Outdoor Recreation Programs & Trips

Outdoor Recreation offers a variety of programs and trips throughout the year such as, white water rafting, hiking, family camping, horseback riding, & tandem skydiving.

*Volunteer opportunities are available, please contact
Outdoor Recreation at 228-3736 for more information.
Like us on Facebook @ www.facebook.com/DMODR*

OUTDOOR RECREATION EQUIPMENT CHECKOUT FEES ACTIVITIES & FACILITIES



3965 S. Craycroft Rd.

Bldg. 4459

Davis-Monthan AFB, AZ 85707

(520)228-3736

dmoutdoorrecreation@gmail.com

Prices also available @ www.dmfss.com

Like us on Facebook @ www.facebook.com/DMODR

Follow us on Instagram! @dmoutdoorrecreation

Current as of Sep 2019

OUTDOOR RECREATION

Location: 3965 S. Craycroft Rd. Bldg. 4459

Phone: 228-3736/4491

Monday to Friday	8:00 am - 5:00 pm
Saturday	10:00 am - 2:00 pm
Sun & Holidays	Closed

OUTDOOR RECREATIONAL POOL

Location: 6090 Quijota Blvd

Phone: 228-3759

Open Season: Memorial Day to Labor Day

Daily Fees: \$2.00 (age 18+) \$1.00 (age 3-17)

INDOOR FITNESS POOL

Inside Benko Fitness Center

Location: Bldg. 2301 on 5th Street

Phone: 228-0015

Monday to Friday	6:00 am - 6:00 pm
Saturday to Sunday	CLOSED
Holidays	CLOSED

For the Rental of All Equipment

A Wkend (weekend) rate: Friday or Saturday pick-up to Monday drop-off

A holiday rate Friday to Tuesday or Thursdays to Monday *IF we are closed on a Monday or Friday for a holiday*

Weekly rate: 7 days, Friday to Thursday, Thursday to Wednesday, ect.

EQUIPMENT RESERVATIONS & DEPOSITS

Equipment rental reservations are accepted on items annotated with two asterisks (). All other equipment is first-come, first-served.**

- **Reservations on tables** can only be for 10 or more tables
- **Reservations on chairs** can only be for 50 or more chairs

A deposit must be charged to a VISA or MasterCard

deposits are mandatory on the following items:

- **\$250.00 deposit:** "Nomad" and "Clipper" camper
- **\$100.00 deposit for each item:** Scamps, boat/motor/trailer, Water Wars, Disc Golf 9-hole set, and "Specialized" road bikes
- **\$50.00 deposit for each item:** mountain and tandem bikes, ElliptiGO, bike trailer, hand cycle, canoes, canopies, deep fryers, boilers, dunk tanks, grills, kayaks, paddle boards, and trolling motors
- **\$25.00 deposit:** bike rack for vehicle
- **\$35.00 deposit:** Santa suits
- **\$15.00 deposit:** Elf suits

All equipment availability & prices are subject to change without notice.

RV STORAGE LOT

Located on Yuma Rd

RV Storage is priced per month

10'x20'	\$35.00
12'x25'	\$41.00
15'x40'	\$48.00
15'x50'	\$50.00

10 days after due date there will be a \$10.00 late fee.

Vehicles must be running with current registration and insurance.

FAM CAMP

Location: 6170 Quijota Blvd, Bldg. 6015

Phone: 520-747-9144

For Military:

Full Hook-Up - \$22.00 per night

Overflow - \$11.00 per night

3 Month Contract - \$2,070.00

5 Month Contract - \$3,473.00

For Guests/Non-military:

Full Hook-Up - \$27.00 per night

Overflow - \$17.00 per night

(non-ID card holders cannot get a 3 or 6 month contract)

Outdoor Recreation has FEDEX EXPRESS

We offer 3-Day Express and Overnight Express. FedEx picks up from our location Monday-Friday, for guaranteed overnight you will need to have your **boxes in to us by 2:00 PM each day. Saturday Delivery** is available dependent on zip code, otherwise overnight boxes dropped off on Friday will be delivered on Monday.

FedEx will pick up any size boxes up to 150 pounds.

An example of our prices: 1 pound envelope overnight for \$13.60

International shipping is available and requires box dimensions, weight, and customs claim amount.

FedEx cannot deliver to PO or APO boxes.

Sorry, FedEx will not pick up GROUND from our facility.

Arizona Armed Forces Recreation Centers

Fort Tuthill

-located in northern Arizona, near Flagstaff

928-774-8893

www.forttuthill.com

Crazy Horse Campground

-located at Lake Havasu

928-269-2267

www.mccsyuma.org

Desert Breeze Travel Camp

-located in Yuma

928-328-3989

www.yumamwr.com

Lake Martinez Recreation Facility

-located on the Colorado River

928-269-2267

www.mccsyuma.org

Fort Huachuca Remote Camping

-Fort Huachuca

520-533-6707

www.mwrhuachuca.com

Squadron Event Loan Items

Squadrons may utilize the following Outdoor Recreation Equipment for official functions ON BASE at minimal charge, with Commander's approval and signature.

***Items are subject to availability.**

<u>Equipment</u>	<u>Daily</u>	<u>Wkend</u>	<u>Holiday</u>	<u>Weekly</u>
20 x 20 Canopy (Assembly Required)	\$10.00	\$20.00	\$25.00	\$50.00
Picnic Kit (Sports kit & Water Cooler)	FREE	FREE	FREE	FREE
Tables (white, folding)	\$1.00 ea.	\$2.00 ea.	\$2.50 ea.	\$5.00 ea.
Chairs (metal, folding, padded)	\$0.50 ea.	\$1.00 ea.	\$1.25 ea.	\$3.00 ea.
Stage (4 - 4 x 8 platforms, 2 stairs and skirt)	\$10.00	\$20.00	\$25.00	\$50.00
Blow Ups \$50.00 deposit each (Jousting Ring, Bounce Castle, Slide)				

Skeet & Trap Range

Our Skeet & Trap Range is located at the end of Yuma Road

Hours of Operation

Thursday, Saturday & Sunday 8:00 am - 12:00 pm (1 October to 30 March)

Thursday, Saturday & Sunday 7:00 am - 11:00 am (1 April to 30 September)

Fees Per Round (25 shots):

\$5.50 (Military), \$6.50 (Guests/Non-military)

20 Round Shot Card—\$104.50 (Military), \$123.50 (Guests/Non-military)

50 Round Shot Card—\$258.50 (Military), \$305.50 (Guests/Non-military)

The Skeet & Trap Range is available for reservation

Reservations must be made in person at Outdoor Recreation.

Security Deposit: \$45.00 (due at reservation on a **Visa or Master Card only**, refundable)

- Reservations need to be made a minimum of 72 hours in advance, a 1 week notice is preferred and will guarantee the reservation date/time.
- Reservations can be made for the hours of 8:00 am to 6:00 pm, Monday through Friday. There is no lighting on the field so shooting will end at sunset.
- Please take into consideration paydays and holidays, and have an alternative date/time if your first choice is not available.
- You must have your own ammunition, the Skeet & Trap Range does not have ammunition for sale.
- You and your guests can pay for your rounds while you are at the range (cash only).

Notice:

The Skeet & Trap Range does not have a credit card capabilities and can only accept cash for rounds.

Camping Equipment

	<u>Daily</u>	<u>Wkend</u>	<u>Holiday</u>	<u>Weekly</u>
Backpack (camping, various sizes)	\$5.00	\$10.00	\$12.50	\$25.00
Trekking Pole	\$4.00	\$8.00	\$10.00	\$20.00
Bow Saw	\$2.00	\$4.00	\$5.00	\$10.00
Camp Chair (red, canvas)	\$4.00	\$8.00	\$10.00	\$20.00
Camp Pad ("egg-shell" or "self-inflating")	\$4.00	\$8.00	\$10.00	\$20.00
Camp Table/Compact (small)	\$4.00	\$8.00	\$10.00	\$20.00
Coffee Pot—12 Cup (aluminum)	\$2.00	\$4.00	\$5.00	\$10.00
Cook Set—6 Piece (aluminum set: 3 pots, 1 pan/lid, 1 lid, 1 detachable handle)	\$3.00	\$6.00	\$7.50	\$15.00
Cook Set—7 Piece (black bag, 2 pots, 1 pan, 2 lids, 1 detachable handle, 1 cutting board)	\$4.00	\$8.00	\$10.00	\$20.00
Cots (roll up or folding)	\$5.00	\$10.00	\$12.50	\$25.00
Dining Set—12 Piece (4 ea: plates, bowls, mugs)	\$4.00	\$8.00	\$10.00	\$20.00
Dutch Oven	\$3.00	\$6.00	\$7.50	\$15.00
Heater—Small for Tent (needs 1 mini propane tank)	\$4.00	\$8.00	\$10.00	\$20.00
Heater—Large for Tent (needs 2 mini propane tanks)	\$5.00	\$10.00	\$12.50	\$25.00
Ice Chest—40 quart	\$3.00	\$6.00	\$7.50	\$15.00
Ice Chest—40 quart (with ice)	\$4.00	\$7.00	\$8.50	\$16.00
Ice Chest—48 quart	\$3.50	\$7.00	\$8.75	\$17.50
Ice Chest—48 quart (with ice)	\$4.50	\$8.00	\$9.75	\$18.50
Ice Chest—68 quart	\$4.00	\$8.00	\$10.00	\$20.00
Ice Chest—68 quart (with ice)	\$6.00	\$10.00	\$12.00	\$22.00
Ice Chest—100 quart	\$5.00	\$10.00	\$12.50	\$25.00
Ice Chest—100 quart (with ice)	\$8.00	\$13.00	\$15.50	\$28.00
Ice Chest—150 quart	\$6.00	\$12.00	\$15.00	\$30.00
Ice Chest—150 quart (with ice)	\$9.00	\$15.00	\$18.00	\$33.00
Lantern propane or electric 4 D batteries	\$4.00	\$8.00	\$10.00	\$20.00
Shovel (camp, small, folding)	\$2.00	\$4.00	\$5.00	\$10.00
Sleeping Bag (various kinds)	\$4.00	\$8.00	\$10.00	\$20.00
Stove, 1-burner propane (needs 1 mini propane tank)	\$3.00	\$6.00	\$7.50	\$15.00
Stove, 2-burner propane (needs 1 mini propane tank)	\$4.00	\$8.00	\$10.00	\$20.00
Tent 2-3 Person Instant Dome Tent	\$8.00	\$16.00	\$20.00	\$40.00
Tent 4-5 Person Instant Dome Tent	\$11.00	\$22.00	\$27.50	\$55.00
Tent 6-Person Instant Tent	\$13.00	\$26.00	\$32.50	\$65.00
Tent 7-8 Person Instant Tent	\$15.00	\$30.00	\$37.50	\$75.00

Towable Camper Trailers

****2012 Scamp, 16 ft. Standard**—fully-enclosed, hard shell travel trailer

Features: sleeps one to four (2 adults, 2 small children), table converts to full bed, sofa converts to bunk beds (no more than 80 pounds on the top bunk), AC and heat, 2-burner stove, 12 gallon water tank, sink with pump, propane tank (we do not fill the propane), and 1.9 cubic ft. mini-fridge. **No toilet.**

Towing information: Requires a class 2 hitch (no bumper hitches), weighs 2000 pounds (unloaded), 16 ft., ball size 2 inches, 7 round electrical plug (no adaptors)

Additional Information: 25 foot 30 amp electric supply cord, battery pack, 30 amp power converter, 12 volt lighting, mounted rear stabilizer jacks, **overall** length 16', height 7' 10", width 6' 8"

Pricing:

Security Deposit: \$100.00, due at reservation on a **Visa or Master Card only**

Daily: \$75.00

Weekend: \$150.00 (Friday or Saturday pick-up to Monday drop-off)

Holiday Weekend: \$187.50 (if we are closed for a holiday: Fri-Tues or Thurs-Mon)

Weekly: \$375.00 (7 days, Friday to Thursday, Thursday to Wednesday, ect.)

Reservation Information:

You can reserve up until 3 months in advance.

Campers require at least 48 hours advanced notice of reservation.

Camper pick up and return is by 3:00 PM Mon through Fri and 1:00 PM Sat

Camper check out/in is extensive and can take up to 1 hour to complete.

NO SMOKING OR PETS ARE ALLOWED IN THE CAMPER

Scamp Floor plan

1. Couch – converts to bunk beds
2. Storage
3. 2-burner stove, and mini-fridge space
4. Table with benches—converts to full bed
5. Sink and cabinet storage
6. Storage (more storage under table benches)
7. Propane and battery attached on the front

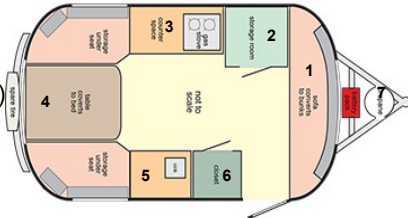

Additional Camper Information

- All campers must be returned clean and with all water tanks empty
- Campers with toilets must have the black-water tanks completely flushed and clean
- If you rent one of our campers you are allowed to dump at Agave Gulch FamCamp (on base) for free
- Fridges can take up to six hours to cool
- Caution and care must be used with awnings and extended or pop-out portions of campers, these items should not be left up/out/extended in high winds

NO PETS OR SMOKING ARE ALLOWED IN OUR CAMPERS

<u>General Use Items</u>	<u>Daily</u>	<u>Wkend</u>	<u>Holiday</u>	<u>Weekly</u>
**Santa Suit (\$35.00 deposit)	\$35.00	\$70.00	\$87.50	\$175.00
**Elf Suit (\$15.00 deposit)	\$15.00	\$15.00	\$15.00	\$15.00
Yard Announcement Sign	\$15.00	\$30.00	\$37.50	\$75.00
<u>Lawn & Garden Tools</u>	<u>Daily</u>	<u>Wkend</u>	<u>Holiday</u>	<u>Weekly</u>
Rake (garden/leaf)	\$3.00	\$6.00	\$7.50	\$15.00
Saw (hand)	\$3.00	\$6.00	\$7.50	\$15.00
Shovel (flat or round head)	\$3.00	\$6.00	\$7.50	\$15.00

HUNTING & FISHING LICENSES

<u>Residency</u>	<u>License Type</u>	<u>Annual Price</u>	<u>Daily Price</u>
Adult (Resident)	Fishing	\$37.00	N/A
Adult (Resident)	Community Fishing	\$24.00	N/A
Adult (Resident)	Hunting	\$37.00	N/A
Adult (Resident)	Combo Hunt/Fish	\$57.00	\$15.00
Adult (Non-Resident)	Fishing	\$55.00	N/A
Adult (Non-Resident)	Combo Hunt/Fish	\$160.00	\$20.00
Youth (Both)	Combo Hunt/Fish	\$5.00	N/A

Waterfowl/Migratory Bird Stamp: \$5.00

Non-permit Hunt Tags: Range between \$15.00-\$135.00, depending on animal

The Youth Combo Hunt and Fish license is required for all children ages 10-17.

Children under 10 do not need a license but must be with an adult with license

- A 1 year license is good 1 year from date of purchase
- All fishing licenses include 2-pole use, all fish, and all lakes, except for the Community Fishing License, which is restricted to city lakes only.
- Military members stationed in Arizona get resident rates

Boats

****Boat "Jon" - Flat bottomed boat**

Towing information: 800 lbs, 14 ft, require a class 2 hitch (no bumper hitches)
1 7/8 inch ball and 4 flat electrical plug (no adaptors)

Features: can seat 3-4, comes on a trailer with a 8 HP motor
seat cushions, life jackets, oars, bailing bucket, anchor

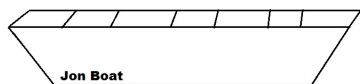

Pricing:

Security Deposit: \$100.00 (due at reservation on a **Visa or Master Card only**, refundable)

Daily: \$40.00

Weekend: \$80.00 (Friday or Saturday pick-up to Monday drop-off)

Holiday Weekend: \$100.00 (if we are closed for a holiday: Fri to Tues or Thurs to Mon)

Weekly: \$200.00 (7 days, Friday to Thursday, Thursday to Wednesday, ect.)

Reservation Information:

You can reserve up until 3 months in advance.

Boats require 24 hour advanced notice of reservation.

Boat pick up and return is by 3:00 PM Monday through Friday and 1:00 PM Saturday

Boat check out/in is extensive and can take up to 30 minutes to complete.

****Boat "Tracker" - V-hull boat**

Towing information: 800 lbs, 14 ft, require a class 2 hitch (no bumper hitches)
1 7/8 inch ball and 4 flat electrical plug (no adaptors)

Features: can seat 3-4, comes on a trailer with a 8 HP motor
seat cushions, life jackets, oars, bailing bucket, anchor

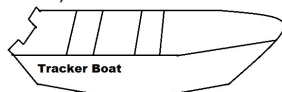

Pricing:

Security Deposit: \$100.00 (due at reservation on a **Visa or Master Card only**, refundable)

Daily: \$45.00

Weekend: \$90.00 (Friday or Saturday pick-up to Monday drop-off)

Holiday Weekend: \$112.50 (if we are closed for a holiday: Fri to Tues or Thurs to Mon)

Weekly: \$225.00 (7 days, Friday to Thursday, Thursday to Wednesday, ect.)

Reservation Information:

You can reserve up until 3 months in advance.

Boats require 24 hour advanced notice of reservation.

Boat pick up and return is by 3:00 PM Monday through Friday and 1:00 PM Saturday

Boat check out/in is extensive and can take up to 30 minutes to complete.

For the rental of ALL Watercraft: Boats, Kayaks & Canoes
A Boaters Safety Course Certificate, certified by the US Coast Guard is required.
These can be acquired with a **FREE online tests** through:
<http://www.boatus.org/arizona>

<u>Other Water Craft & Fishing Equipment</u>	<u>Daily</u>	<u>Wkend</u>	<u>Holiday</u>	<u>Weekly</u>
**Canoe (\$50.00 deposit)	\$15.00	\$30.00	\$37.50	\$75.00
**Canoe or Kayak Trailer	\$10.00	\$10.00	\$10.00	\$10.00
Fishing Pole	\$4.00	\$8.00	\$10.00	\$20.00
**Kayak-Ocean or Pedal (\$50.00 deposit) Ocean Kayak: sit-on-top Pedal Kayak: foot-powered propellers	\$20.00	\$40.00	\$50.00	\$100.00
Life Jackets (various sizes)	\$4.00	\$8.00	\$10.00	\$20.00
**Paddle Boards (\$50.00 deposit)	\$15.00	\$30.00	\$37.50	\$75.00
Paddles/Oars	\$3.00	\$6.00	\$7.50	\$15.00
Seat Cushions	\$3.00	\$6.00	\$7.50	\$15.00
**Trolling Motor & Battery (\$50.00 deposit)	\$25.00	\$50.00	\$62.50	\$125.00

Towable Camper Trailers

**** "Nomad" 2014 Skyline Nomad 163 Retro Expandable Travel Trailer, 18 ft.**

Features: sleeps up to seven, two pop-out queen beds on each end, table converts to full bed, sofa can be used as a bed, heat, **AC (runs on 30 amp only)**, 2-burner stove, 17 gallon water tank, sink with pump, and 3 cubic ft. mini-fridge, **toilet**, shower, microwave, AM/FM/CD stereo with 4 speakers, 1 propane tank (we do not fill the propane)

Towing information: Requires a class 2 hitch (no bumper hitches), weighs 2820 pounds (unloaded), 18 ft., ball size 2 5/16 inches, 7 round electrical plug (no adaptors)

Additional Information: 35 amp 12 volt power convertor with 120 volt load center, battery pack, 25 foot 35 amp electric supply cord, 6 gallon gas water heater, 12 volt lighting, rear stabilizing jacks, **overall** length 18', height 9'1", width 7'

Pricing:

Security Deposit: \$250.00, due at reservation on a **Visa or Master Card only**

Daily: \$100.00

Weekend: \$200.00 (Friday or Saturday pick-up to Monday drop-off)

Holiday Weekend: \$250.00 (if we are closed for a holiday: Fri-Tues or Thurs-Mon)

Weekly: \$500.00 (7 days, Friday to Thursday, Thursday to Wednesday, ect.)

Reservation Information:

You can reserve up until 3 months in advance.

Campers require at least 48 hours advanced notice of reservation.

Camper pick up and return is by 3:00 PM Mon through Fri and 1:00 PM Sat

Camper check out/in is extensive and can take up to 1 hour to complete.

NO SMOKING OR PETS ARE ALLOWED IN THE CAMPERS

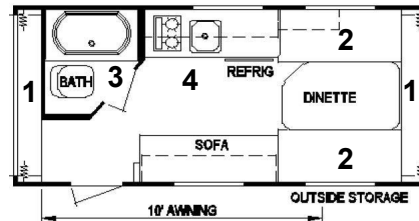

Model 163

Floor plan

1. Pop-out beds (both ends of the trailer)
2. Benches with storage underneath
3. Bathroom with toilet and shower
4. 2-burner stove, sink, mini-fridge

Additional Camper Information

- All campers must be returned clean and with all water tanks empty
- Campers with toilets must have the black-water tanks completely flushed and clean
- If you rent one of our campers you are allowed to dump at Agave Gulch FamCamp (on base) for free
- Fridges can take up to six hours to cool
- Caution and care must be used with awnings and extended or pop-out portions of campers, these items should not be left up/out/extended in high winds

NO PETS OR SMOKING ARE ALLOWED IN OUR CAMPERS

Group Event Items	Daily	Wkend	Holiday	Weekly
**Blow ups (\$50.00 Deposit) with rental of fairway 10 or Eagles Nest (Jousting Ring, Slide, Bounce Castle)				
**Canopy 10'x10' (\$50.00 deposit, has 10 ft. poles)	\$35.00	\$70.00	\$87.50	\$175.00
**Canopy 20'x20' (\$50.00 deposit, has 20 ft. poles, requires trailer for transport)	\$45.00	\$90.00	\$112.50	\$225.00
Cambro (5 gallon, hot or cold drink holder & dispenser)	\$5.00	\$10.00	\$12.50	\$25.00
**Chairs —black, folding, padded <i>reservations on chairs can only be for 50 or more chairs</i> Bulk Rental Discounts: 25+ chairs \$1.00 per chair per day 25+ 50+ chairs \$.75 per chair per day 50+	\$1.50 \$1.00 \$.75	\$3.00 \$2.00 \$1.50	\$3.75 \$2.50 \$1.85	\$7.50 \$5.00 \$3.75
Coffee Pot —Makes 101 Cups	\$5.00	\$10.00	\$12.50	\$25.00
**Deep Fryer with Strainer / Boiler (\$50.00 deposit)	\$15.00	\$30.00	\$37.50	\$75.00
**Dunk Tank (\$50.00 deposit, 500 gal)	\$40.00	\$80.00	\$100.00	\$200.00
**Grill—Charcoal—Towable (\$50.00 deposit, fits about 75 hamburgers)	\$40.00	\$80.00	\$100.00	\$200.00
**Grill—19' x 5'4" Custom Smoker (\$100.00 deposit, fits about 15 turkeys) Towing Requirements: a class 4 hitch, 2 5/16" ball, weighs 8000 lbs	\$60.00	\$120.00	\$150.00	\$300.00
**Grill—Rotisserie—Towable (\$50.00 deposit, fits about 50 hamburgers)	\$35.00	\$70.00	\$87.50	\$175.00
**Grill—Small—Towable (\$50.00 deposit, fits about 50 hamburgers, 1 7/8 in ball)	\$30.00	\$60.00	\$75.00	\$150.00
**Grill—Texas—Towable (\$50.00 deposit, fits about 75 hamburgers, 2 in ball)	\$40.00	\$80.00	\$100.00	\$200.00
**Horse/Water Trough (small & large)	\$6.00	\$12.00	\$15.00	\$30.00
Old Smokey Grill	\$10.00	\$20.00	\$25.00	\$50.00
**Picnic Kit (Softball set, Tug-o-War rope, Volleyball system, Horseshoes & various sports balls)	\$32.00	\$64.00	\$80.00	\$100.00
Stage 6 Pieces (4– 4x8 platforms , 2 stairs and skirt)	\$30.00	\$60.00	\$75.00	\$95.00
**Tables —6'x2.5' rectangle, black or white, seat 6-8 <i>reservations on tables can only be for 10 or more tables</i> Bulk Rental Discounts: 10+ tables \$2.00 per table per day 10+ 20+ tables \$1.50 per table per day 20+	\$3.00 \$2.00 \$1.50	\$6.00 \$4.00 \$3.00	\$7.50 \$5.00 \$3.75	\$15.00 \$10.00 \$7.50
Water Jugs (for cold drinks, 5 gallons with dispenser)	\$4.00	\$8.00	\$10.00	\$20.00
**Water Wars (\$100.00 deposit, sling-shot water balloon game, requires a trailer)	\$35.00	\$70.00	\$87.50	\$175.00
**Weber Grill (\$50.00 Deposit)	\$10.00	\$20.00	\$25.00	\$50.00

For the rental of Grills & Dunk Tanks: Preferably 24 hours advanced notice of reservation, towable weight 100-500 lbs, 8-10 ft, requires a class 2 hitch (no bumper hitches), 4 flat electrical plug (no adaptors) & 1 7/8 or 2 inch ball. Grill check out/in can take up to 30 minutes to complete. Grills come with a propane tank customer is responsible for filling.

Sports & Games	Daily	Wkend	Holiday	Weekly
Badminton Set (outdoor game)	\$4.00	\$8.00	\$10.00	\$20.00
Balls (various sports)	\$2.00	\$4.00	\$5.00	\$10.00
Baseball Bases	\$4.00	\$8.00	\$10.00	\$20.00
Batting Helmet	\$2.00	\$4.00	\$5.00	\$10.00
Bike—ElliptiGO (\$50.00 deposit, elliptical bike) Hourly Rates: \$5.00 for 2 hours (minimum); \$3.00 each additional hour	\$25.00	\$50.00	\$62.50	\$125.00
**Bike—Mountain (\$50.00 deposit) Hourly Rates: \$3.00 for 2 hours (minimum); \$2.00 each additional hour	\$15.00	\$30.00	\$37.50	\$75.00
**Bike—Rack for Vehicle (\$25.00 deposit)	\$15.00	\$30.00	\$37.50	\$75.00
**Bike—SPECIALIZED Road Bike (\$100.00 deposit) Hourly Rates: \$5.00 for 2 hours (minimum); \$3.00 each additional hour	\$25.00	\$50.00	\$62.50	\$125.00
**Bike—Tandem (\$50.00 deposit, bicycle for 2) Hourly Rates: \$4.00 for 2 hours (minimum); \$2.50 each additional hour	\$20.00	\$40.00	\$50.00	\$100.00
**Bike—Trailer (\$50.00 deposit, for children)	\$10.00	\$20.00	\$25.00	\$50.00
Boccee Ball (outdoor game, weighted ball toss, needs sand or grass)	\$5.00	\$10.00	\$12.50	\$25.00
Croquet	\$5.00	\$10.00	\$12.50	\$25.00
Catchers Mask—Baseball	\$2.00	\$4.00	\$5.00	\$10.00
Corn Hole (outdoor game, bean-bag toss)	\$8.00	\$16.00	\$20.00	\$40.00
Disc Golf—Disc Sets (3 discs)	\$4.00	\$8.00	\$10.00	\$20.00
Flag Football	\$5.00	\$10.00	\$12.50	\$25.00
Golf Clubs	\$10.00	\$20.00	\$25.00	\$50.00
Horseshoe Set	\$4.00	\$8.00	\$10.00	\$20.00
Ladder Ball (outdoor game, rope/ball toss)	\$5.00	\$10.00	\$12.50	\$25.00
Softball Bat	\$3.00	\$6.00	\$7.50	\$15.00
Softball Glove	\$4.00	\$8.00	\$10.00	\$20.00
Spike Ball	\$5.00	\$10.00	\$12.50	\$25.00
Tennis Racquet	\$2.00	\$4.00	\$5.00	\$10.00
**Trikke (\$50.00 deposit, 3-wheeled scooter) Hourly Rates: \$4.00 for 2 hours (minimum); \$2.50 each additional hour	\$12.00	\$24.00	\$30.00	\$60.00
Tug-of-War Rope	\$4.00	\$8.00	\$10.00	\$20.00
Volleyball System (net, poles, ball)	\$17.00	\$34.00	\$42.50	\$85.00
Washer Game Set (outdoor game, washer toss)	\$5.00	\$10.00	\$12.50	\$25.00